

1 PLANTA REDE PLUVIAL
Escala: 1:500

TABELA DE TUBOS DA REDE REDE PLUVIAL

| TUBO | DN (m) | COMPRIMENTO (m) | DECLIVIDADE (%) |
|------|--------|-----------------|-----------------|
| 04 | 0.40 | 3.048 | 0.86% |
| 05 | 0.40 | 2.475 | 1.28% |
| 20 | 0.40 | 6.114 | 2.14% |
| 19 | 0.40 | 11.406 | 6.53% |
| 16 | 0.40 | 3.374 | 4.29% |
| 17 | 0.40 | 2.335 | 1.32% |
| 18 | 0.40 | 20.214 | 0.50% |
| 01 | 0.40 | 4.195 | 17.69% |
| 02 | 0.40 | 2.121 | -2.79% |
| 07 | 0.40 | 4.257 | 0.50% |
| 23 | 0.40 | 2.579 | 3.87% |
| 22 | 0.40 | 4.057 | 0.50% |
| 21 | 0.40 | 4.325 | 1.73% |
| 14 | 0.40 | 7.510 | 1.32% |
| 12 | 0.40 | 9.532 | 0.50% |
| 11 | 0.40 | 7.712 | 4.99% |
| 13 | 0.40 | 5.964 | 0.50% |
| 06 | 0.60 | 25.191 | 5.54% |
| 25 | 0.60 | 1.806 | 0.50% |
| 08 | 0.60 | 1.507 | 0.50% |
| 09 | 0.60 | 22.347 | 7.17% |
| 26 | 0.60 | 24.453 | 6.11% |
| 24 | 0.60 | 14.313 | 0.50% |
| 03 | 0.60 | 24.995 | 3.51% |

TABELA DE ESTRUTURAS DA REDE REDE PLUVIAL

| NOME | COTAS | PROFUNDIDADE (m) |
|------|--------------------------|------------------|
| 01 | CT= 726.50 CF= 725.30 | 1.200 |
| 03 | CT= 725.77 CF= 724.57 | 1.200 |
| 02 | CT= 725.46 CF= 724.26 | 1.200 |
| 05 | CT= 724.93 CF= 723.73 | 1.200 |
| 04 | CT= 724.92 CF= 723.72 | 1.200 |
| 06 | CT= 724.90 CF= 723.70 | 1.200 |
| 19 | CT= 723.77 CF= 722.57 | 1.200 |
| 07 | CT= 723.50 CF= 722.30 | 1.200 |
| 09 | CT= 723.49 CF= 722.29 | 1.200 |
| 08 | CT= 723.49 CF= 722.30 | 1.191 |
| 16 | CT= 723.20 CF= 722.00 | 1.200 |
| 20 | CT= 723.06 CF= 721.86 | 1.200 |
| 23 | CT= 723.00 CF= 721.80 | 1.200 |
| 17 | CT= 723.00 CF= 721.80 | 1.200 |
| 13 | CT= 723.00 CF= 721.80 | 1.200 |
| 22 | CT= 723.00 CF= 721.80 | 1.200 |
| 24 | CT= 723.00 CF= 721.80 | 1.123 |
| 21 | CT= 722.99 CF= 721.79 | 1.200 |
| 26 | CT= 722.99 CF= 721.79 | 1.200 |
| 18 | CT= 722.98 CF= 721.78 | 1.079 |
| 14 | CT= 722.97 CF= 720.93 | 1.978 |
| 11 | CT= 722.93 CF= 721.73 | 1.200 |
| 25 | CT= 722.76 CF= 721.80 | 0.955 |
| 12 | CT= 722.92 CF= 720.98 | 1.540 |
| 10 | CT= 721.85 CF= ??? | 1.185 |
| 15 | CT= 721.84 CF= 720.80 | 0.750 |
| 27 | CT= 721.26 CF= ??? | 1.185 |

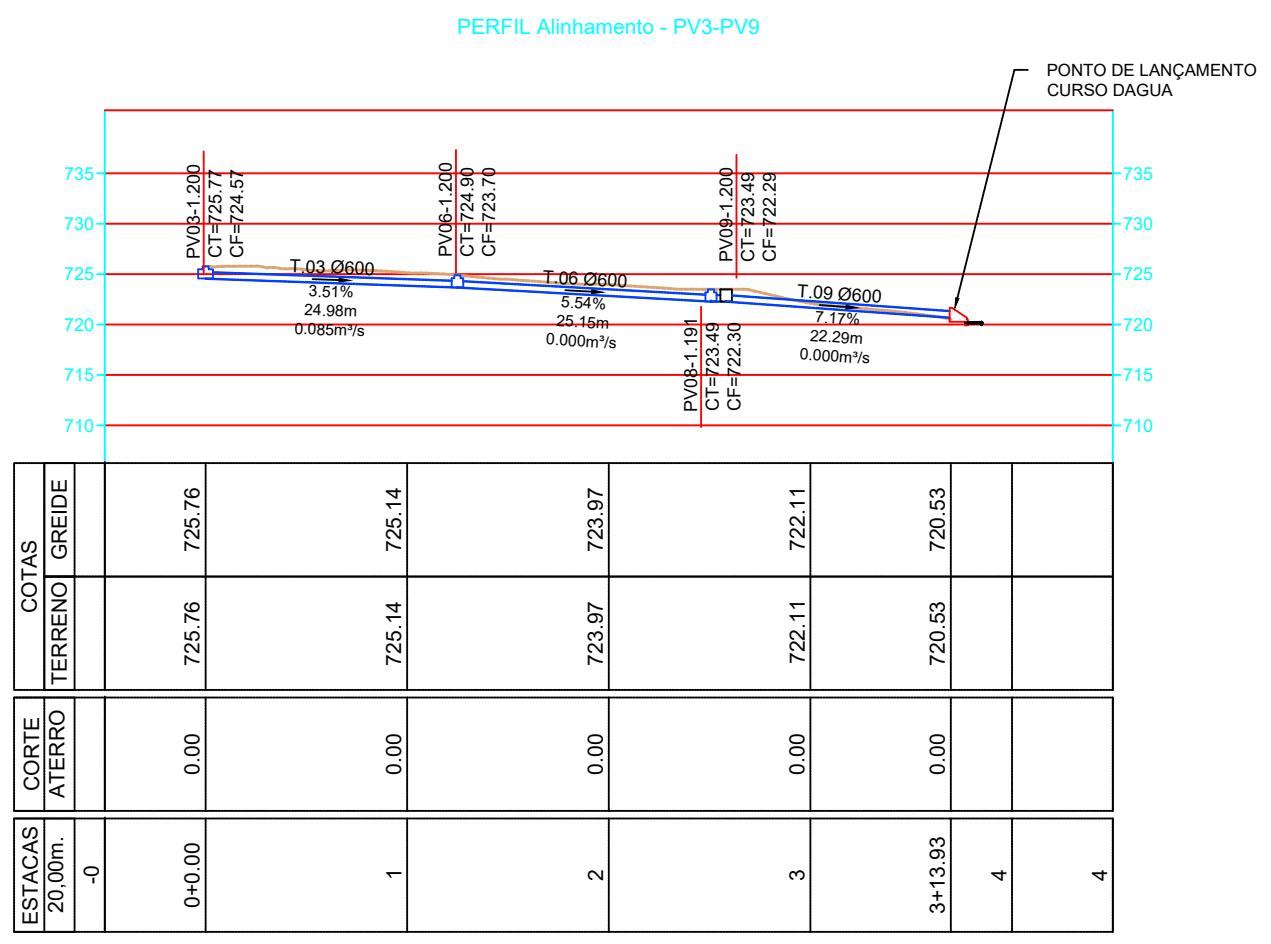
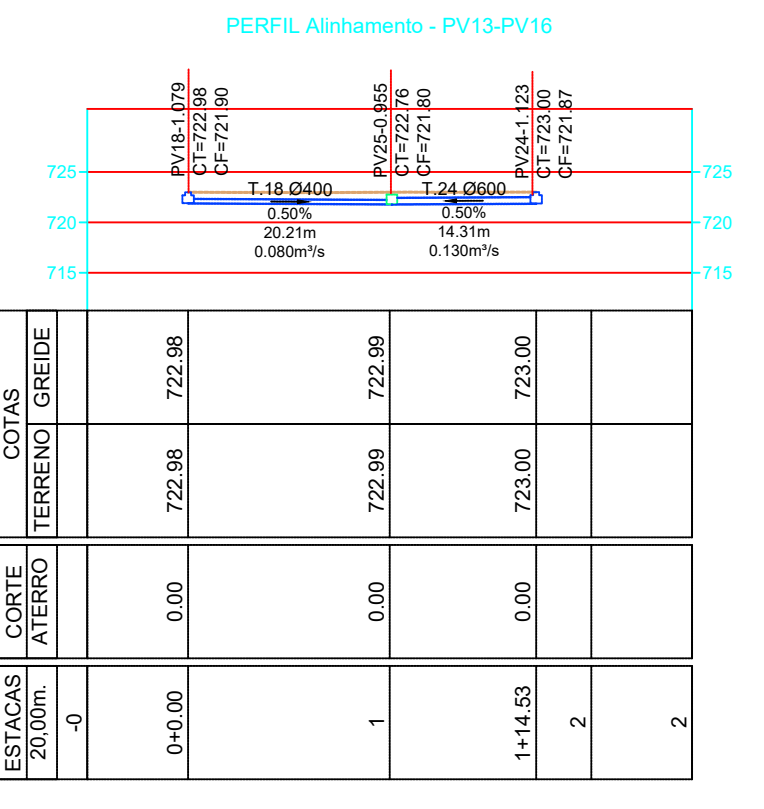

MEIO-FIO E SARJETA DE CONCRETO - SEM ESCALA

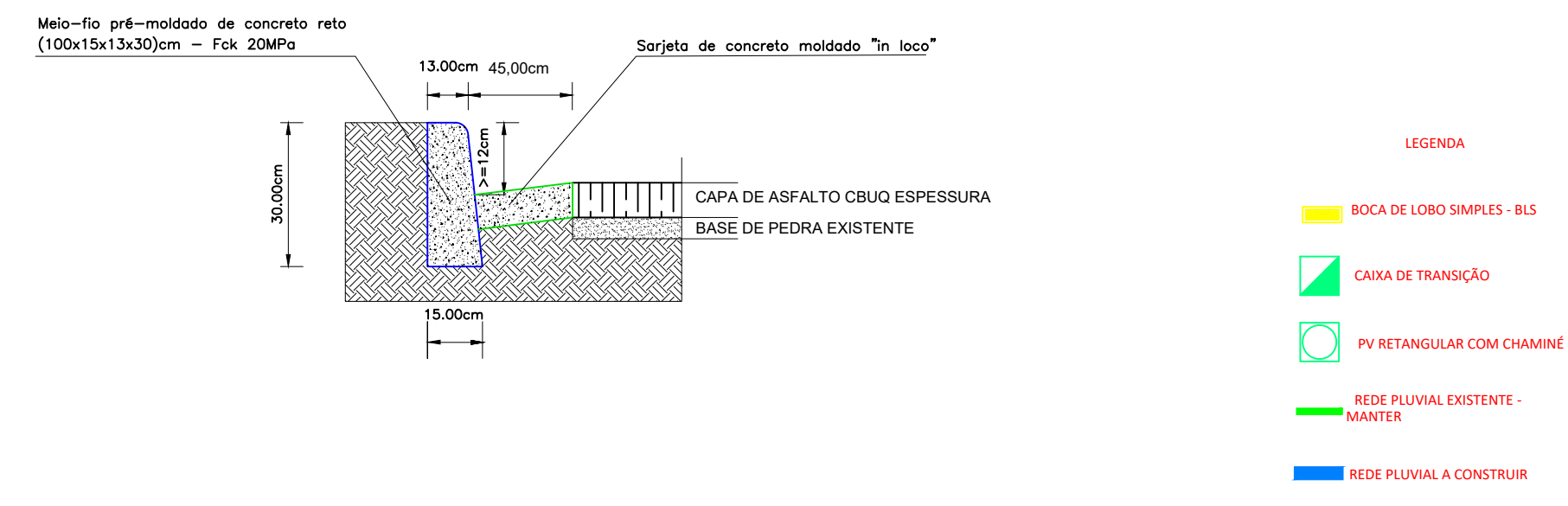

DETALHE 08: BOCA DE LOBO

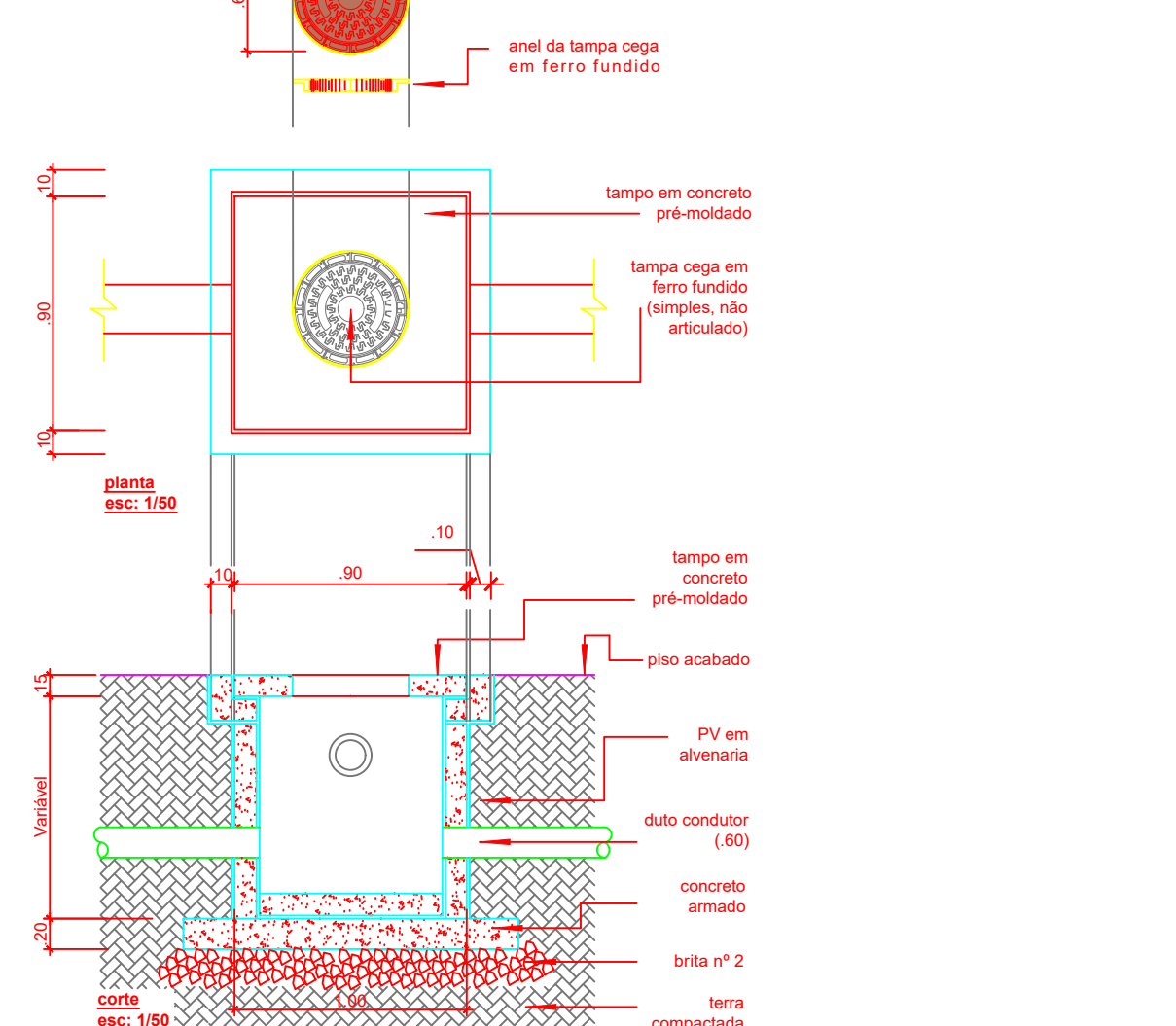
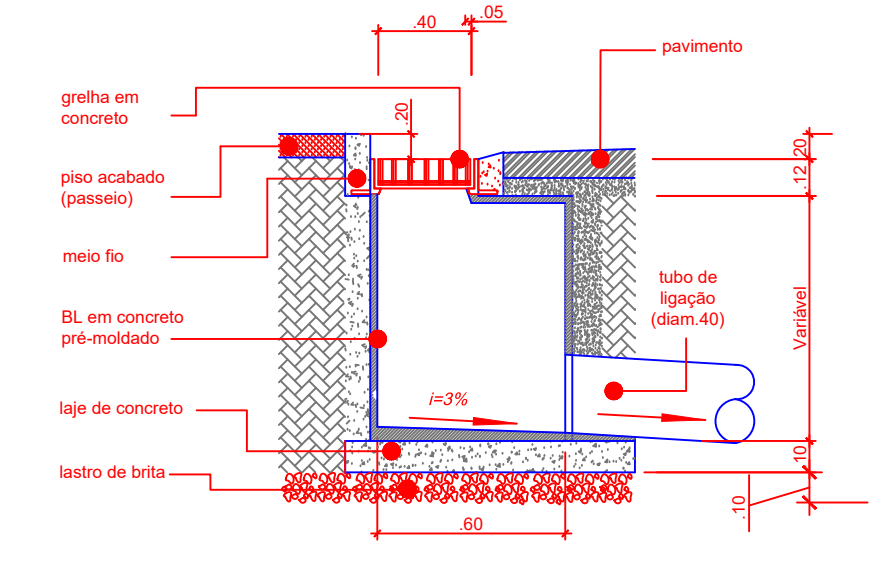

DETALHE DA GRELHA

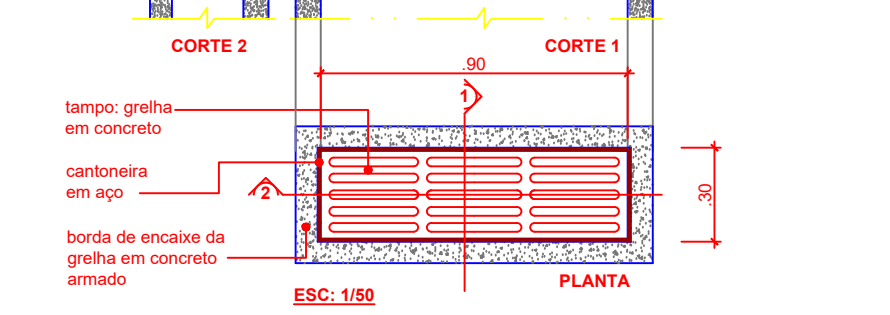

DISSIPADOR DE ENERGIA SEM ESCALA

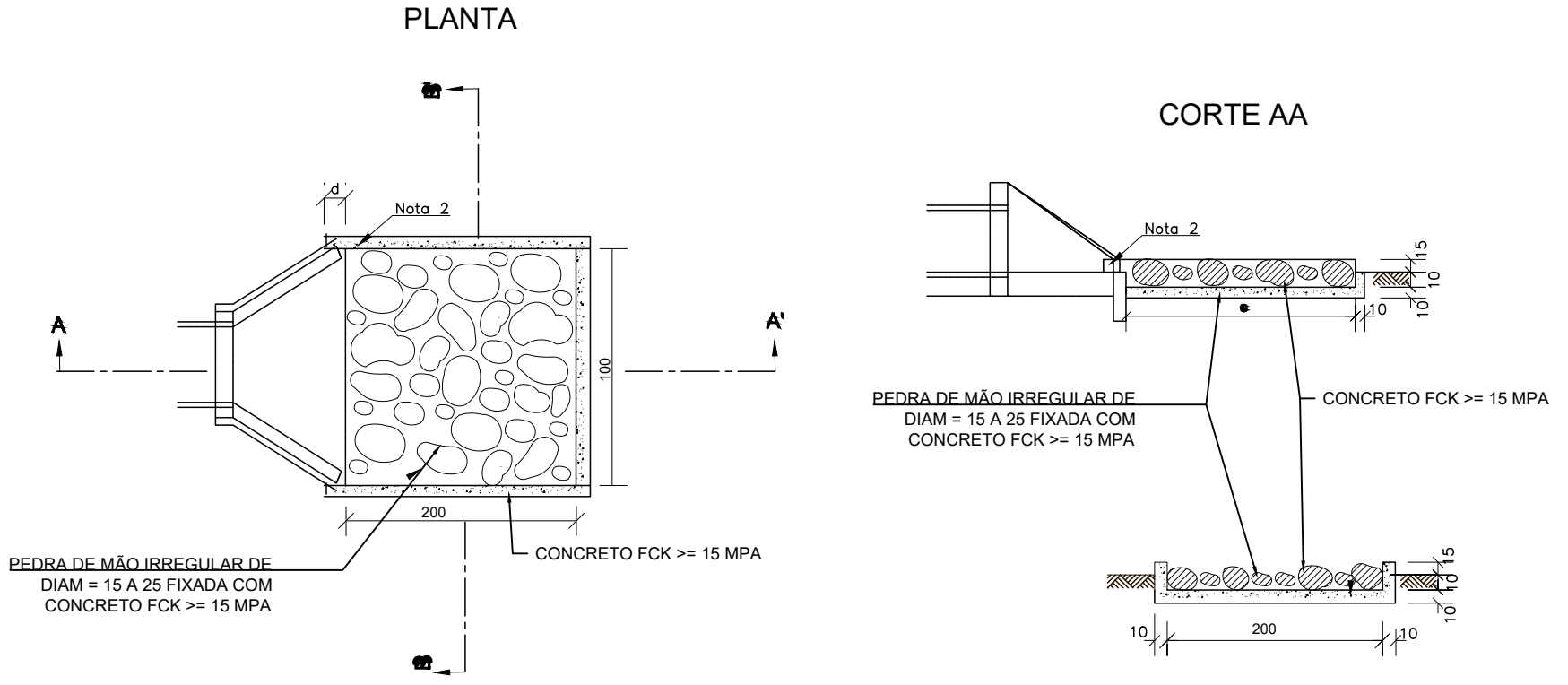

PREFEITURA MUNICIPAL DE COIMBRA
Rua Afonso de Barros, 80 - Centro - CEP: 36.550-000 - COIMBRA - MG
C.G.C.: 18.132.464/0001-17 - Telefax: (32) 355-1152 / 355-1214

PROPRIETÁRIO: PREFEITURA MUNICIPAL DE COIMBRA
CNPJ: 181.324.64/0001-17

DESENHO: JOÃO ADELMO LESSA
ENG. CIVIL - CREA 58756/D

PROJETO: DRENAGEM
CONTEUDO: PLANTA - DETALHES
OBRA: PAVIMENTAÇÃO COM ASFALTO

ENDEREÇO: RUA JACYR FREDERICO
FOLHA: 5 DE 5
DATA: 10/01/2023
ÁREA: - m²